

**University of Colorado**  
**Release from Responsibility, Assumption of Risk and Waiver**

Name \_\_\_\_\_

Activity UCCS Student Garden at the Heller Center Date \_\_\_\_\_

Address \_\_\_\_\_

Phone Number (\_\_\_\_\_) \_\_\_\_\_ Email Address (required) \_\_\_\_\_

I exercise my own free choice to participate in the above designated Activity. **I understand and assume all associated risks. I agree to assume all risk of personal injury or loss, bodily injury (including death), damage to or loss or destructions of any personal property occurring in connection with or arising out of participation in the UCCS Student Garden at the Heller Center.**

I understand by signing this waiver I have read and agree to comply with the following:

- I. Requirements while participating in gardening:
  - A. Smoking, open flames, fires, fireworks and other flammable devices are prohibited at the Heller Center.
  - B. Entry to all buildings with the exception of the designated gardening tool location is prohibited.
  - C. Entry into designated construction zones is prohibited.
  - D. It is suggested that all participants work in groups of two or more. If you do not and are working alone, you must contact the campus police at 255-3111 and advise them you are working at the garden prior to beginning work.
  - E. Operating hours for the garden are from dawn to dusk. If you need to work outside of these hours, please contact campus police at 255-3111.
  - F. Park motorized vehicles in designated parking spaces only. The area by the barn has designated parking (please see map on reverse).
  - G. Compliance with the Knox Box interconnection method for locking the gate is required. Please see instructions and photograph attached to this waiver.
- II. Strongly recommended:
  - A. It is strongly recommended that all gardening participants wear sturdy boots and appropriate clothing including gloves.
  - B. Drinking water is not always available. It is recommended you bring drinking water with you.
  - C. Out of courtesy to our neighbors, we ask that you please enter the Heller estate from the North Campus Heights road off of North Nevada.

I hereby release and discharge, indemnify and hold harmless the Regents of the University of Colorado, and their member officers, agents, employees and any other persons or entities acting on their behalf, and the successors and assigns for any and all of the aforementioned persons and entities, against all claims, demands, costs and expenses, and causes of action whatsoever, either in law or equity, arising out of or in any way connected with any loss and/or bodily injury and/or disability, arising from my participation in the Activity.

I have had sufficient time to review and seek explanation of the provisions contained above, have carefully read them, understand them fully, and agree to be bound by them. After careful deliberation, I voluntarily give my consent and agree to this Release, Assumption of Risk and Waiver.

In the event of an emergency, I grant the University of Colorado permission to authorize emergency medical treatment for \_\_\_\_\_, (participant) for the duration of his/her participation in this Activity. **I understand that University of Colorado does not carry or provide health or accident insurance that responds to injury or illness as a result of my participation in this Activity.**

Medical Health Insurance Company \_\_\_\_\_ Policy # \_\_\_\_\_

Emergency Contact/Phone \_\_\_\_\_

If the participant is under 18 years of age, the parent or guardian in consideration of this request accepts the above terms and grants permission for the student's participation.

\_\_\_\_\_  
Participant Signature (Parent or Guardian if under 18)

\_\_\_\_\_  
Date

Please turn in this waiver to the UCCS Police Department. An original signed waiver is required. All annual affirmations of the waiver will be conducted electronically through e-mail.

# Garden site

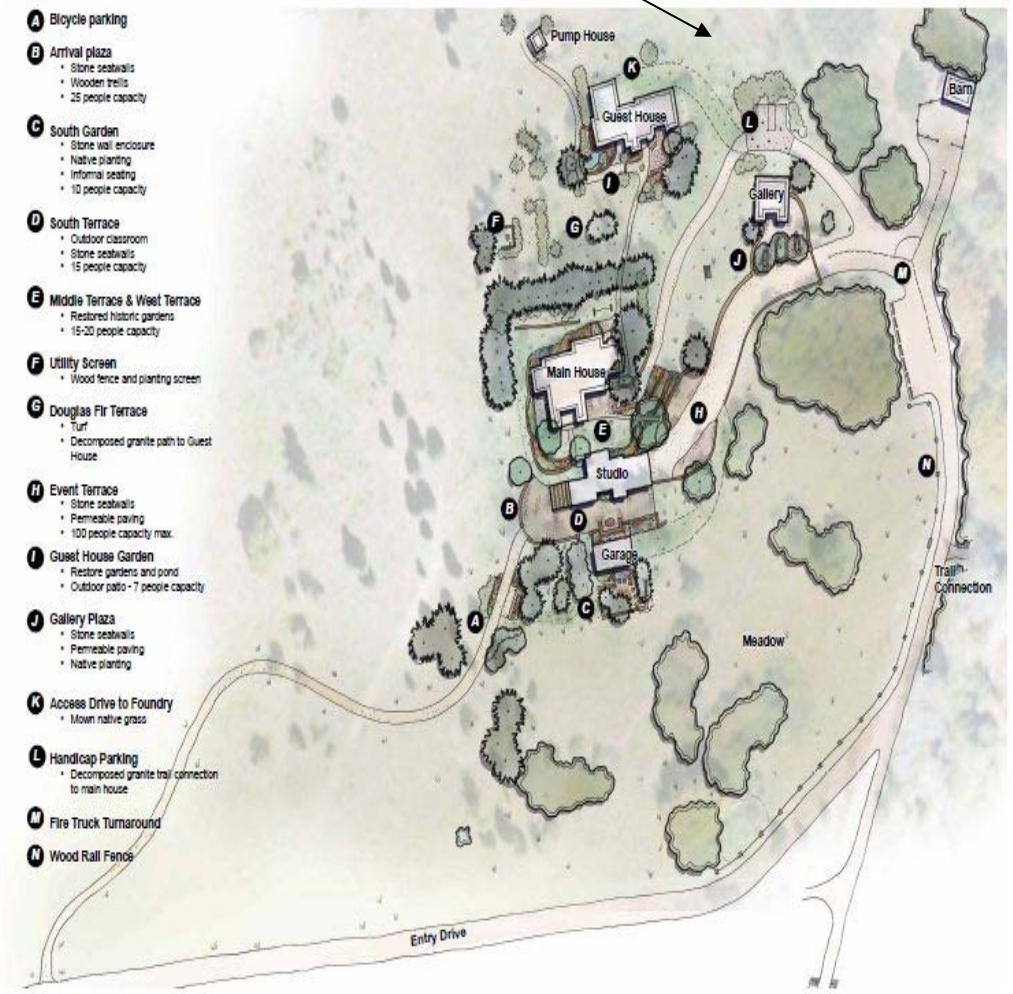

- A** Bicycle parking
- B** Arrival plaza
  - Stone seatwalls
  - Wooden trellis
  - 25 people capacity
- C** South Garden
  - Stone wall enclosure
  - Native planting
  - Informal seating
  - 10 people capacity
- D** South Terrace
  - Outdoor classroom
  - Stone seatwalls
  - 15 people capacity
- E** Middle Terrace & West Terrace
  - Restored historic gardens
  - 15-20 people capacity
- F** Utility Screen
  - Wood fence and planting screen
- G** Douglas Fir Terrace
  - Turf
  - Decomposed granite path to Guest House
- H** Event Terrace
  - Stone seatwalls
  - Permeable paving
  - 100 people capacity max.
- I** Guest House Garden
  - Restore gardens and pond
  - Outdoor patio - 7 people capacity
- J** Gallery Plaza
  - Stone seatwalls
  - Permeable paving
  - Native planting
- K** Access Drive to Foundry
  - Mown native grass
- L** Handicap Parking
  - Decomposed granite trail connector to main house
- M** Fire Truck Turnaround
- N** Wood Rail Fence

Historic core area plan (not to scale).



## CORRECT METHOD

Note that both locks are inter-connected so that if the fire department unlocks their lock (the red one) the chain and the gate are unlocked. When locking up, the two locks need to be inter-connected as shown.



---

## INCORRECT MOTHOD

Lower lock is the fire department lock. If the fire department unlocked their lock, the chain and gate would still be locked.

