

# KEY NOTES

- 1 INSTALL 400 LF TYPE 1 8" CURB & GUTTER WITH FILL (3' WIDE) BEHIND CURB; REPAIR MILLINGS ADJACENT CURB.
- 2 INSTALL 12' CURB OPENING W/ 5' CONCRETE PAN W/CUT OFF WALL, 82 LF SWALE A, & 20'Wx15'Lx3'D TYPE H RIPRAP PAD AT BOTTOM.
- 3 CONSTRUCT 0.25 AC FT WATER QUALITY DETENTION POND, W/OUTLET STRUCTURE, 80 LF 18" RCP W/FES, 140 LF OF 10' DIRT MAINTENANCE ROAD AND RIPRAP OVERFLOW AT EMBANKMENT. REQUIRES IMPORT OF 1500 CY +/- . SEE POND DETAILS.
- 4 CONSTRUCT 130 LF SWALE B TO EXISTING CHANNEL.
- 5 REPAIR/PATCH 1,500 SY (1,414 SY AS SHOWN) OF POTHOLES IN PARKING AREA WITH 2" HOT MIX ASPHALT.
- 6 INSTALL EROSION CONTROL IN CONFORMANCE WITH VOLUME 2 OF THE COLORADO SPRINGS DRAINAGE MANUAL - SILT FENCE AT TOE OF SLOPES; INLET PROTECTION; & RESEED ALL DISTURBED AREAS.

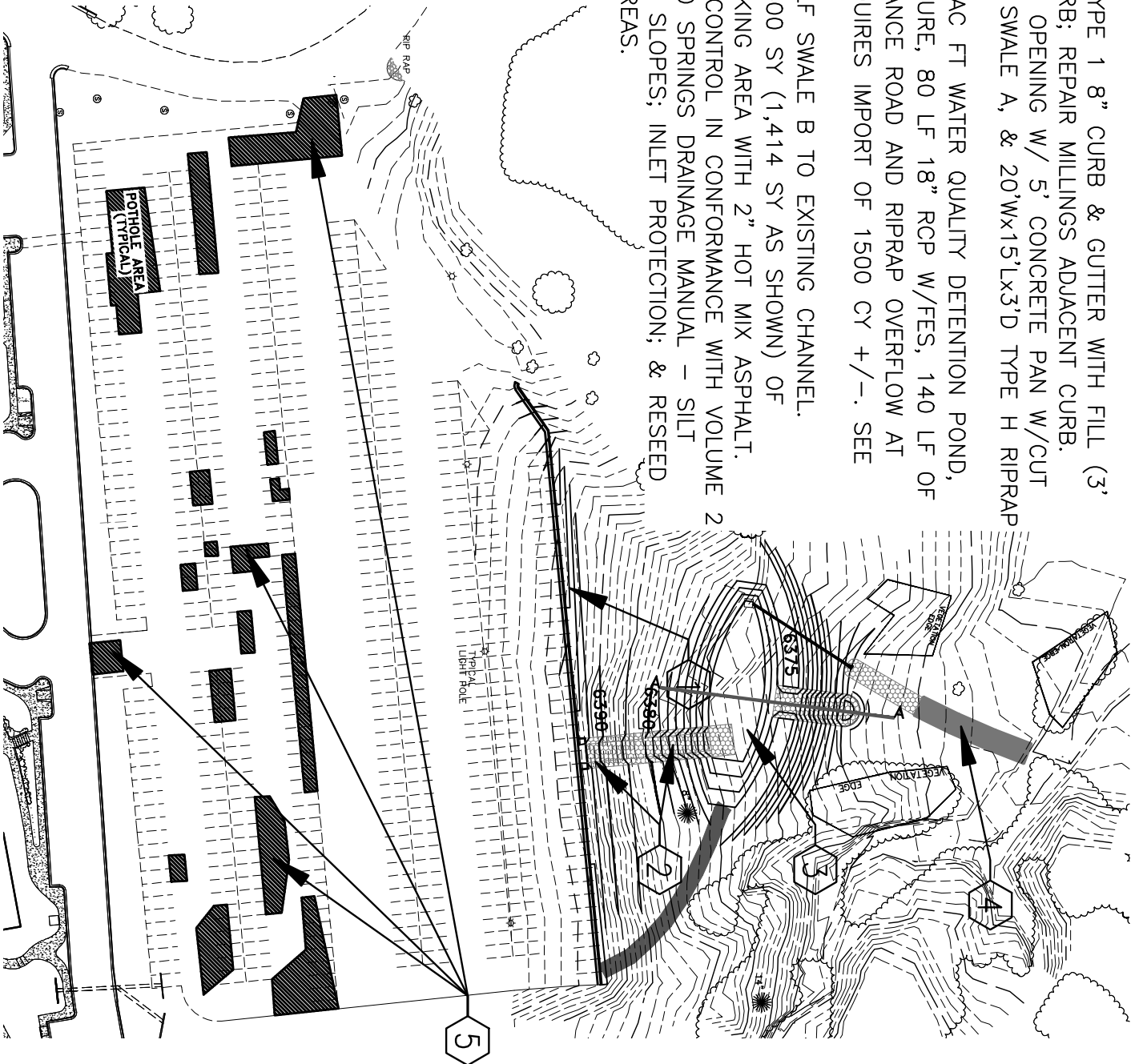

SCALE: 1" = 100'



**PLAN PREPARED BY:**  
**Bradley B. Bean, PE**  
 ENGINEERING & SOFTWARE  
 419 East Columbia Street  
 Colorado Springs, CO 80907  
 (719) 578-9391

## LOT 9 SITE PLAN

**THE UNIVERSITY OF COLORADO  
 AT COLORADO SPRINGS**

DATE: 05/20/08

ADDENDUM #1

# C2.0