

ROTATING MACHINERY ANCHOR BOLTS—
MUST GO THROUGH HOUSEKEEPING SLAB
AND ANCHOR INTO STRUCTURAL SLAB

#3 @ 12"
EACH WAY

4" THICK
"HOUSEKEEPING"
PAD (TYPICAL)

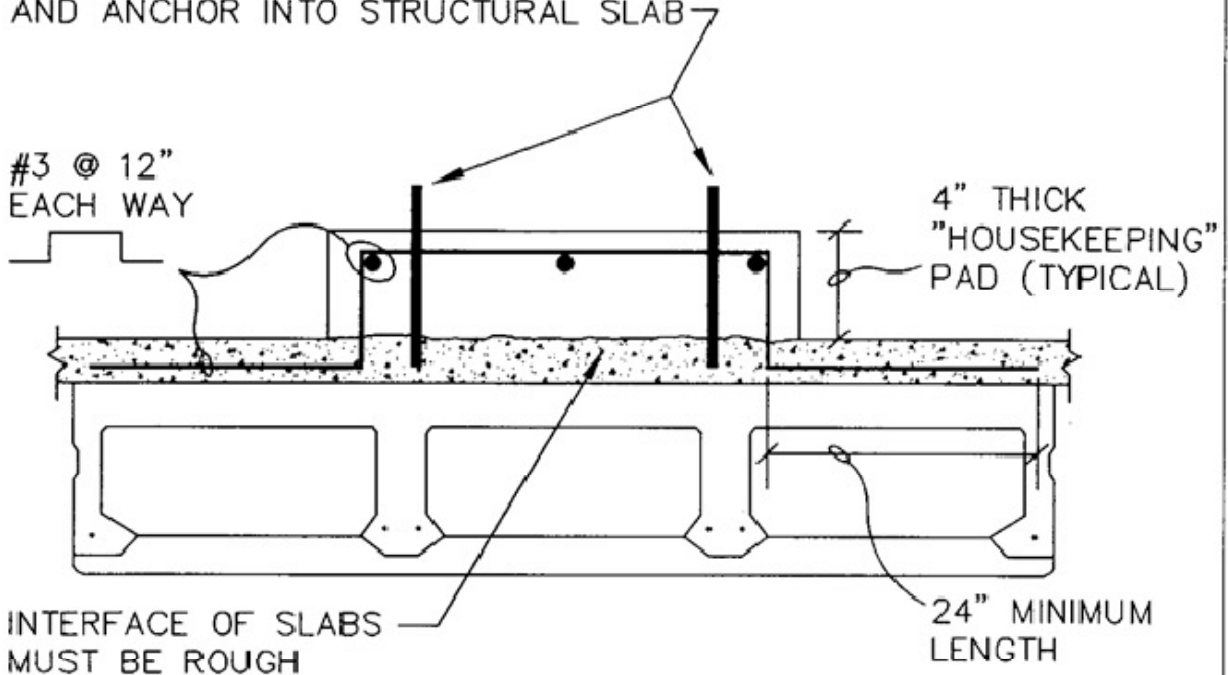

NO SCALE

This schematic depicts a satisfactory rotating machinery base system. The cited details can be used for either steel or concrete support beams (a precast beam is shown). Other methods could be used to accomplish the desired objective. The objective is simply to make the rotating machinery, housekeeping slab and structure work together in resisting unbalanced forces.

**Adopted by UCCS Standards
712008**